



24 Queens Road

, Portsmouth, PO2 7NA

Offers over £375,000

Older style semi detached family home / Three double bedrooms / Three reception rooms / Impressive kitchen/diner with centre island / Many period features throughout / South facing rear garden / Modern fitted bathroom / Downstairs WC / Driveway parking / Close to shops and good access to the motorway

- Older style semi detached family home
- Three double bedrooms
- Three reception rooms
- Impressive kitchen/diner with centre island
- Many period features throughout
- South facing rear garden
- Modern fitted bathroom
- Downstairs WC
- Driveway parking
- Close to shops and good access to the motorway

Viewing

Please contact our ROK Marsh Office on 02393233267 if you wish to arrange a viewing appointment for this property or require further information.



3



2



2



D

Floor Plan

Area Map

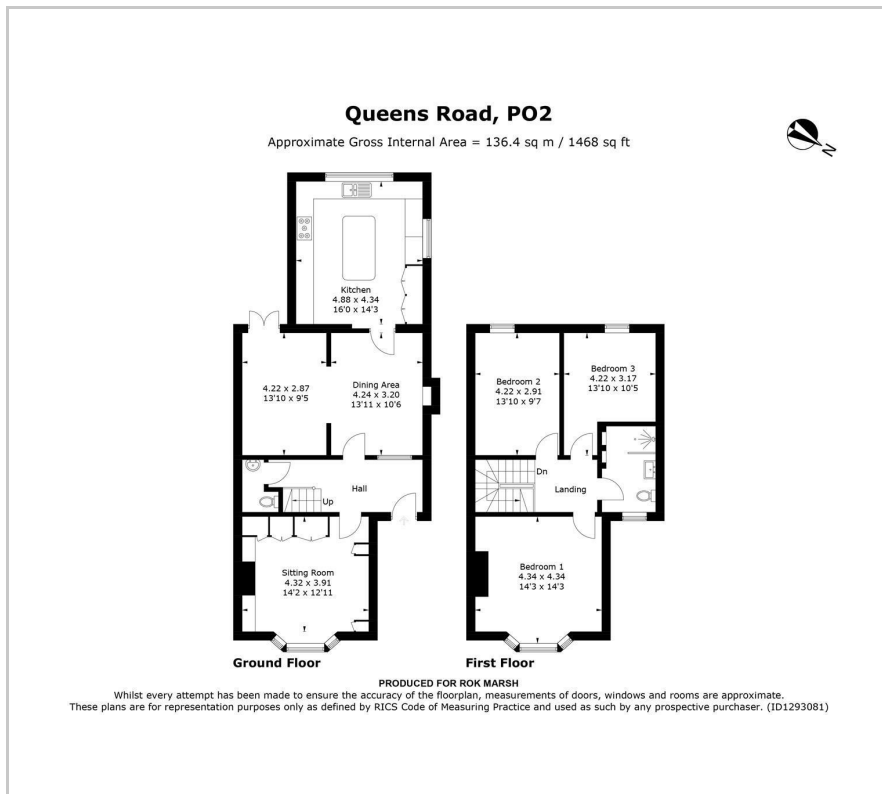

Energy Efficiency Graph

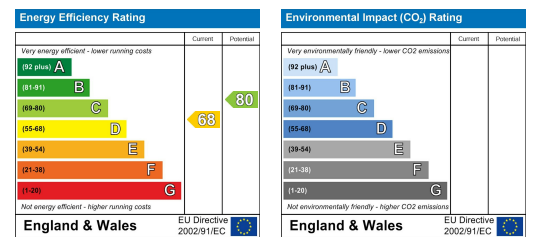

These particulars, whilst believed to be accurate are set out as a general outline only for guidance and do not constitute any part of an offer or contract. Intending purchasers should not rely on them as statements of representation of fact, but must satisfy themselves by inspection or otherwise as to their accuracy. No person in this firm's employment has the authority to make or give any representation or warranty in respect of the property.